

Pos. Nr. Pos.no.	Beschreibung Description	Art.-Nr. Art.no.	Preisgruppe Price bracket
1	Motor Motor	85142	28
2	Stromabnehmer Pantograph	85549	19
3	Schraube M 2 x 4 Screw M 2 x 4	85670	3
4	Schraube M2x10 Screw M2x10	114854	3
5	Schraube M 2 x 14 Screw M 2 x 14	117245	3
6	Gelenkwelle Cardan shaft	87138	4
7	Hauptleitung lang Main wire, long	91995	3
8	Hauptleitung kurz Main wire, short	92943	3
9	Stirnfenster Front window	110342	6
10	TS - Scheinwerfer Part set - Headlights	92921	7
11	Scheinwerferbrücke Headlight bridge	110341	4
12	Kohlebürste Carbon brush	89743	6
13	Blitzschutzgerät Lightning protector	93807	3
14	Dachleiter Roof step	93809	3
15	Bürstenfeder Carbon brush spring	114197	3
16	Einhornhupe Typhon	110345	3
17	Seitenfenster Side windows	110309	11
18	Brückenstecker Connector	100644	6
19	Drahtlampe T1 16V/30mA Light bulb T1 16V/30mA	109321	8
20	Motorplatine kpl. Motor PCB complete	129041	20
21	Grundrahmen Main frame	110295	16
22	Inneneinrichtung Interior	110297	5
23	Oberleitungsverbinder Overhead supply connector	110303	6
24	Lichtabdeckung Light cover	110306	3
25	Dachaufsatz Dormer cover	110308	6
26	Griffstange Handrail	110344	3
27	Verriegelungshebel Locking lever	110343	3
28	Drahtlampe 16V Vtb Light bulb 16V Vtb	135118	10
29	GF-Schraube M 2 x 5 GF-Screw M 2 x 5	114966	3
30	Isolatorsatz Insulator set	120006	10
31	Gehäuse kpl. Betr. Nr. BB 8177 Casing assembly loco no BB 8177	144286	33

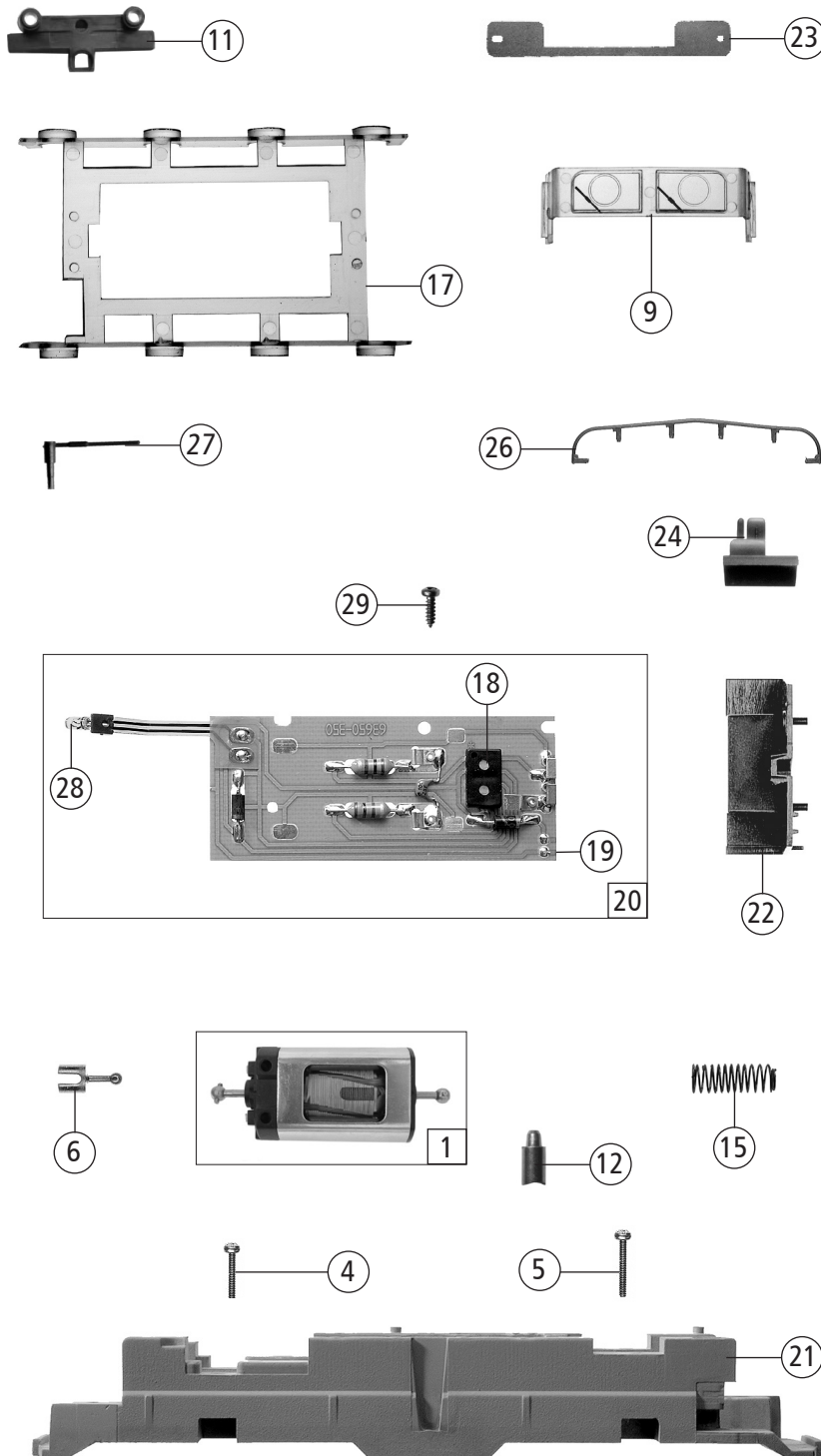

Änderungen in Konstruktion und Ausführung vorbehalten  
We reserve the right to change the construction and specification

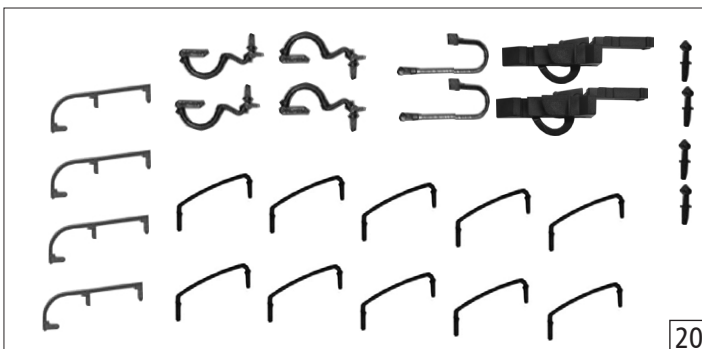
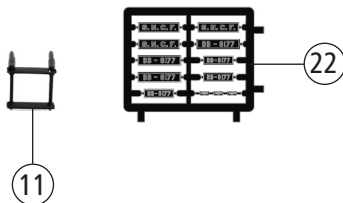
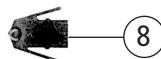
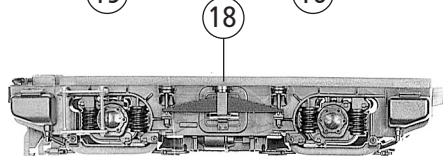
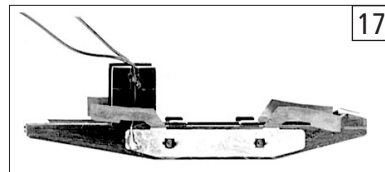
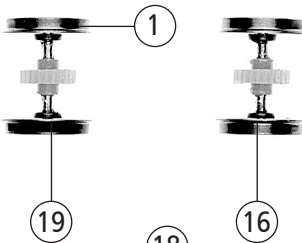
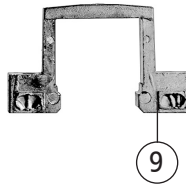
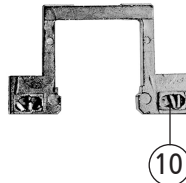
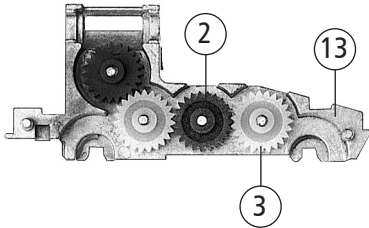
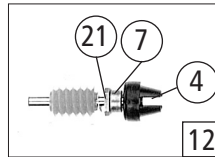
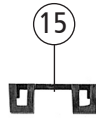
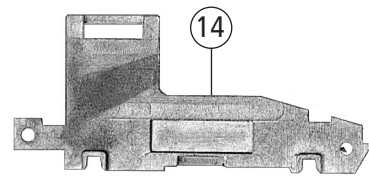

73051		SNCF BB 8100		≡	
Pos. Nr. Pos.no.	Beschreibung Description	Art.-Nr. Art.no.	Preisgruppe Price bracket		
1	Hafringsatz DC Set with traction tires DC	40070	---		
2	Zahnrad Z=23 Gear Z=23	86420	3		
3	Zahnrad Z=23 L Gear Z=23 L	86423	3		
4	Kardanschale kurz 1,5mm Cardan bearing short 1,5mm	87129	4		
5	Puffer halbbrund Buffer	110340	3		
6	Standardkupplung kpl. Standard coupling assembly	89246	6		
7	Lager für Schneckenachse Bearing for Worm axle	89749	6		
8	Kupplungskammer Coupling chamber	121421	3		
9	Bügel 1 Frame 1	93115	9		
10	Bügel 2 Frame 2	93116	9		
11	Leiter Step	93094	3		
12	Schneckensatz Worm set	101697	13		
13	Getriebe ohne Zahnräder Gear without gear	101704	9		
14	Getriebedeckel Gear cover	101705	8		
15	Schneckendeckel Worm cover	105109	5		
16	Radsatz ohne Hafring Wheelset without traction tires	110329	11		
17	Kontaktrahmen kpl. Current contact frame ass.	110330	12		
18	Drehgestellblende Bogie frame	110762	6		
19	Radsatz mit 2 Hafringen Wheelset with 2 traction tires	110332	12		
20	Zurüstbeutel Bag with accessories	110346	13		
21	Anlaufscheibe Washer	114622	3		
22	Tafelsatz Set of panels	144287	12		

Ersatzteile erhalten Sie bei Ihrem Fachhändler,  
oder Ihrer Landesvertretung.

You can order your Replacement Parts at your  
local dealer, your country representative.